

# FITTING INSTRUCTIONS: SIDE STEPS

Part No: 30H96D

RG HOLDEN COLORADO / ISUZU DMAX CREW CAB

Model Commencing 06/2012



**ENDCAPS:** Front – 1 pair Standard **endcaps**  
Rear – 1 pair Bent **endcaps**

**STEPPADS:** Front – 1 pair with 'INTEGRA' label  
Rear – 1 pair PLAIN

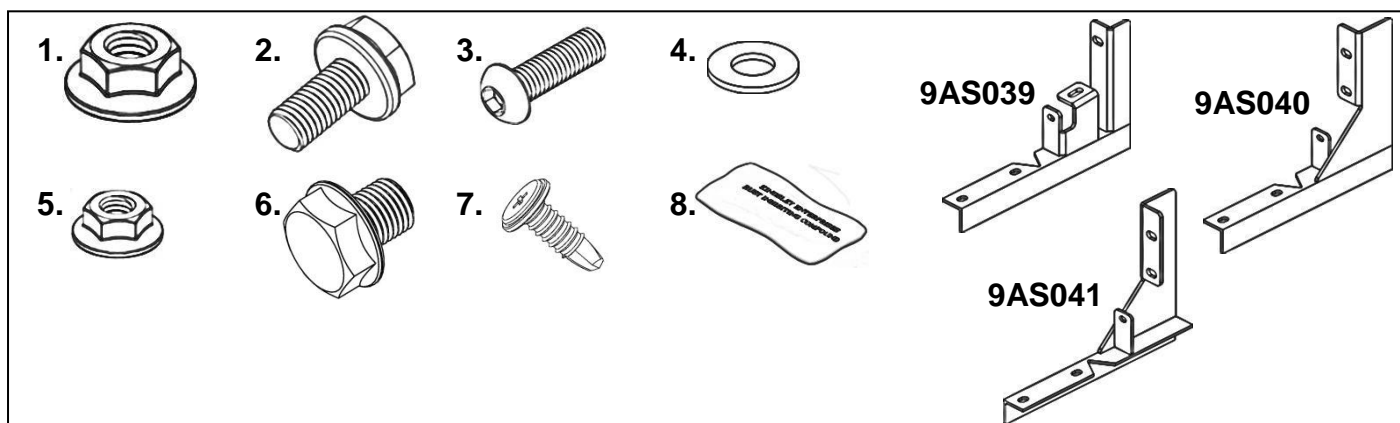

HARDWARE KIT CONTENTS		
ITEM NO.	DESCRIPTION	QTY
1	M8 Flange Nut	6
2	M8 x 20 Flange Bolt	6
3	M6 x 30 Button Head Cap Screw	2
4	M6 Flat Washer	2

ITEM NO.	DESCRIPTION	QTY
5	M6 Flange Nut	2
6	M8 x 11 Flange Bolt	12
7	8G x 12mm Truss Head	16
8	Rust Inhibitor	1

STEPBOARD BRACKETS		
PART NO.	DESCRIPTION	QTY
9AS039	Front & Centre Common Bracket	4
9AS040	Drivers Side Rear Bracket	1
9AS041	Passenger Side Rear Bracket	1
-	-	-

**BEFORE INSTALLATION:** PLEASE READ THESE INSTRUCTIONS CAREFULLY BEFORE INSTALLATION, PAYING SPECIAL ATTENTION TO ALL 'NOTES'. FAILURE TO DO SO MAY RESULT IN DAMAGE OF PARTS AND/OR INJURY TO INSTALLER OR CUSTOMER.

**TOOLS REQUIRED:** • TAPE MEASURE • 13MM SOCKET & RATCHET • 10MM & 13MM RING/OPEN SPANNER  
• 4MM ALLEN KEY • TORQUE WRENCH

# FITTING PROCEDURE:    **Approx. fitting time 45 mins**

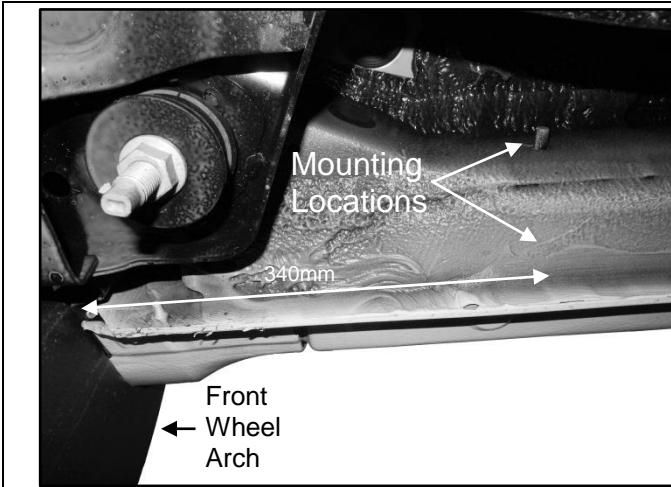

**Step 1. Move to the R/H (Driver's) side of the vehicle.** Locate the M8 stud and captive nut at the front mounting position, approximately 340mm from the front wheel arch.

**Note:** For Colorado models, use a scribe to remove the round sticker that covers the captive nut, as shown. For DMAX models, remove plastic plug.

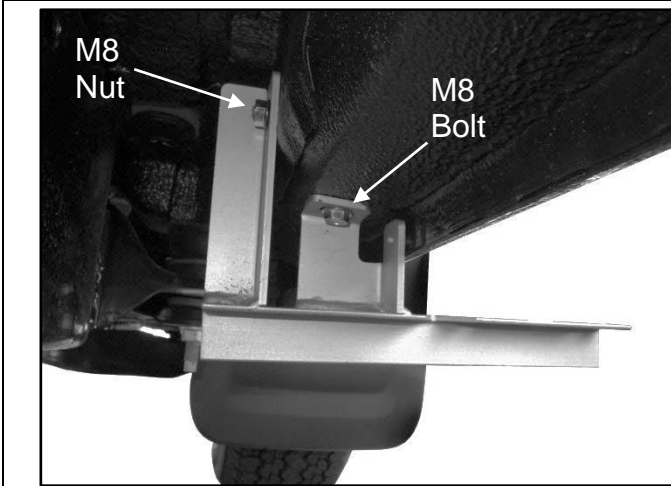
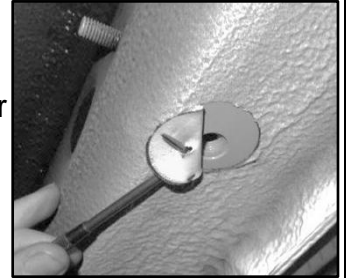

**Step 2.** Attach the Front & Centre Common Bracket [9AS039] using 1x M8 Flange Nut [Item 1] and 1x M8x20 Flange Bolt [Item 2] at the front mounting location. Ensure bracket is level and square, and then tighten to **Max Torque 13 Nm**.

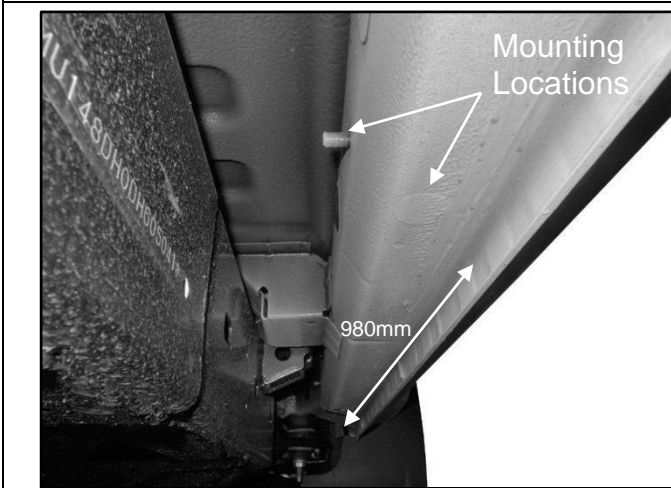

**Step 3.** Locate the M8 stud and captive nut at the centre mounting position, approximately 980mm from the front wheel arch.

**Note:** Remove sticker or plug as described in Step 1.

Repeat **Step 2** for centre bracket fitment.

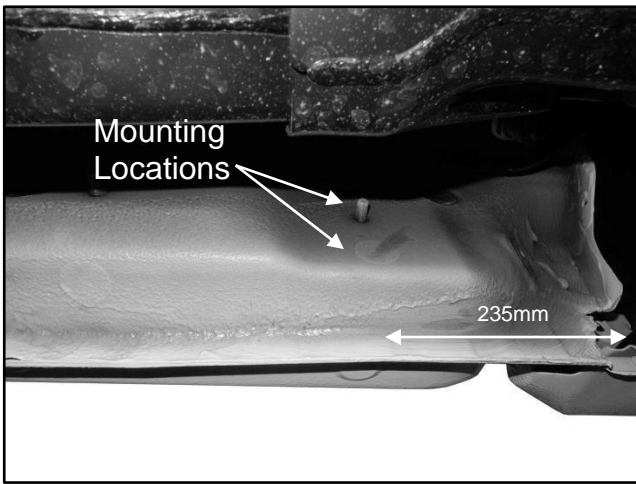

**Step 4.** Locate the M8 stud and captive nut at the rear mounting position, approximately 235mm from the rear wheel arch.

**Note:** Remove sticker or plug as described in Step 1.



**Step 5.** Loosely fit the Drivers Side Rear Bracket [9AS040] using 1x M8 Flange Nut [Item 1] and 1x M8x20 Flange Bolt [Item 2] at the rear mounting location.

**Note:** Finger tighten only

Ensure bracket is level and square, then mark the sill mounting position through the hole in the front plate. Replicate mark onto outside of sill in preparation for drilling.



**Step 6.** Remove rear bracket from vehicle, then use a 3mm drill bit to pilot drill the mounting hole location. Enlarge the hole using 6.5mm drill bit.

Apply rust inhibiting compound [Item 8] to the drilled hole.

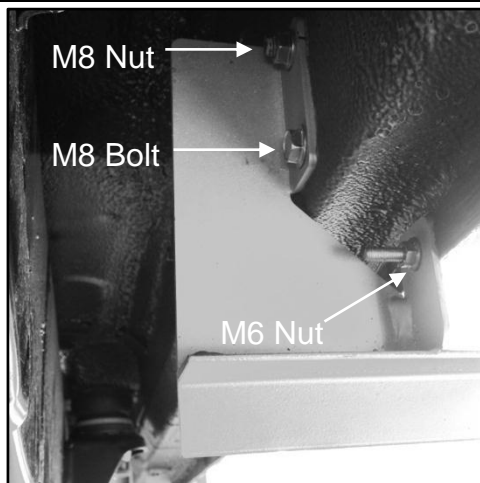

**Step 7.** Refit the Drivers Side Rear Bracket [9AS040] as described in Step 5.

Insert 1x M6x30 Button Head Cap Screw [Item 3] and 1x M6 Flat Washer [Item 4] through the hole in the sill and the bracket and secure with 1x M6 Flange Nut [Item 5]

Tighten M8 fasteners to **Max Torque 13 Nm**.  
Tighten M6 fasteners to **Max Torque 10 Nm**.

Passenger (L/H) side

Labelled Step Pad (Front)

Plain Step Pad (Rear)

Place step pads on board. As a guide, fit step pads under door centres.

**STEP 8: OPTIONAL**

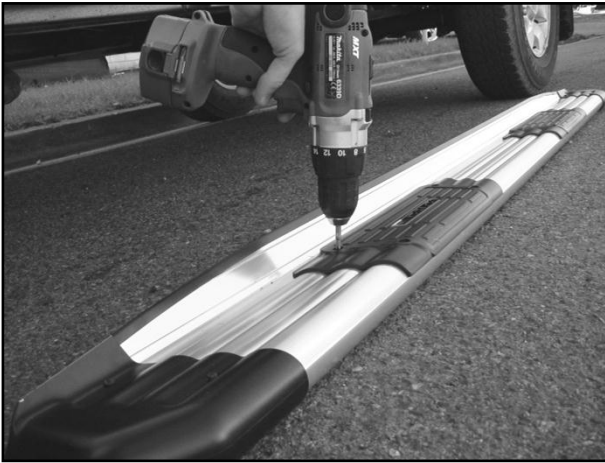

**Step 8. OPTIONAL:** Step pads can be installed on board. As a guide fit step pads under door centres, using 4x 8Gx12 Truss HD SDS [Item 7] per step pad.



**Step 9.** Install stepboard to all brackets using 2x M8x11 mm Flange Bolt [Item 6] per bracket. Position stepboard 5-10 mm behind front mud flap.

**Tighten all M8 bolts to 13 Nm.**

**10. Now complete steps 1 – 9 for the L/H (Passenger) side of vehicle.**

- Place “**KINGSLEY SIDE STEP Warranty**” on customer’s front seat
- Clean the side steps if necessary using PH - Neutral soapy water **ONLY**