



# Kingsley **ROGUE**

## FITTING INSTRUCTIONS

**Part No: 50F98D**  
**FORD RANGER DUAL CAB**  
**Commencing 05/2022**



### Kit Contents (Approximate Fitting Time: 60 minutes)

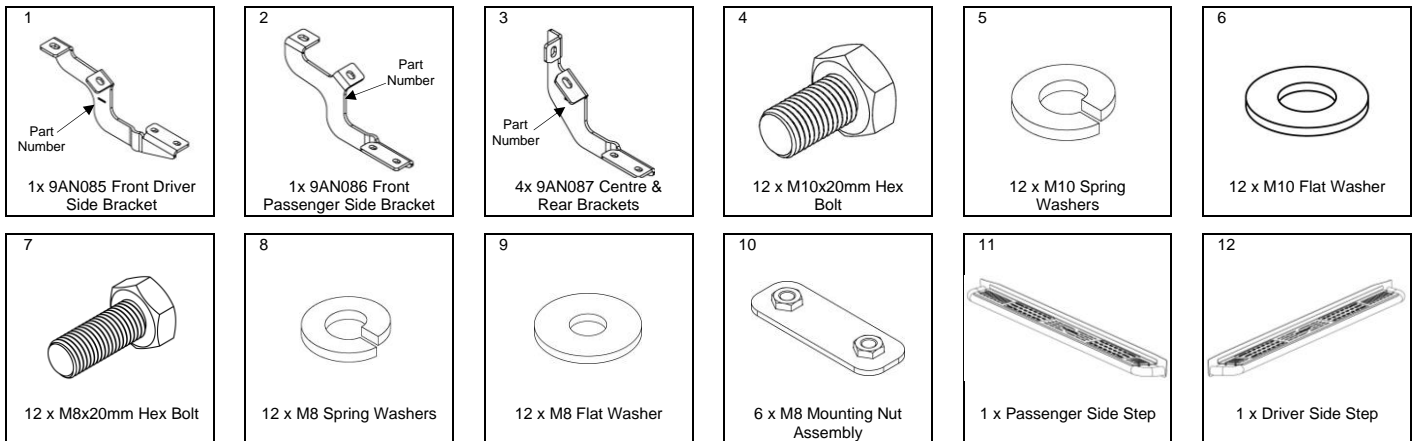

**TOOLS REQUIRED:** • Tape Measure • 13 & 16mm Sockets / Spanners • Torque Wrench

**BEFORE INSTALLATION:** Please read these instructions carefully before installation, paying special attention to all 'Notes'. Failure to do so may result in damage of parts and/or injury to the installer or customer. Place side steps in a safe place until required. Check the contents of this kit before commencing fitment & report any discrepancies.

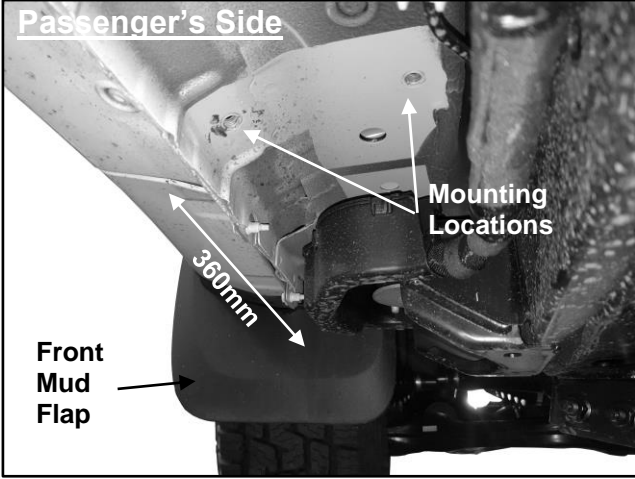

**Step 1. Move to the L/H (Passenger's) side of the vehicle.**

Remove the factory step from the vehicle if fitted, then locate the front bracket mounting position, approximately 360mm from the front mud flap.

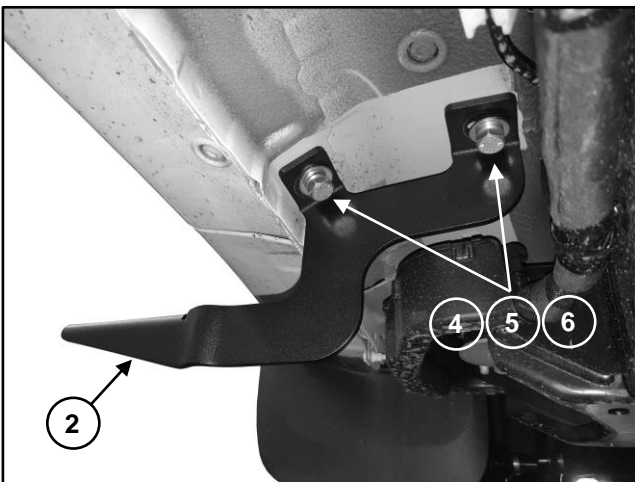

**Step 2. Attach the Front Passenger Side Bracket [Item 2] to the front mounting position using:**  
 2 x M10 Hex Bolts [Item 4]  
 2 x M10 Spring Washers [Item 5]  
 2 x M10 Flat Washers [Item 6]

Ensure the bracket is level and square, then finger tighten only.

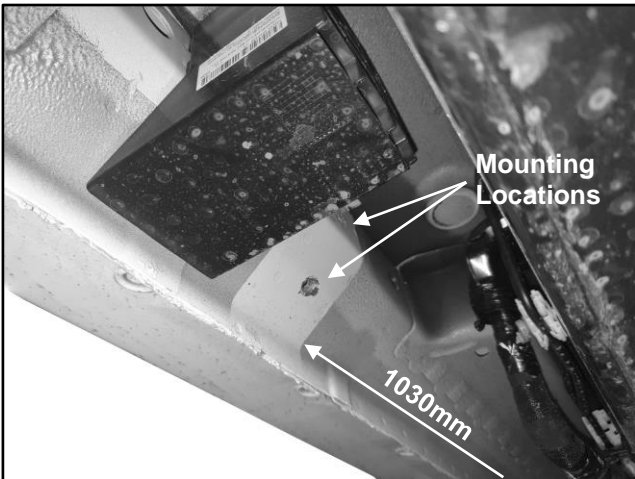

**Step 3. Move to the centre of the vehicle.**

Locate the centre bracket mounting position, approximately 1030mm from the front mud flap.

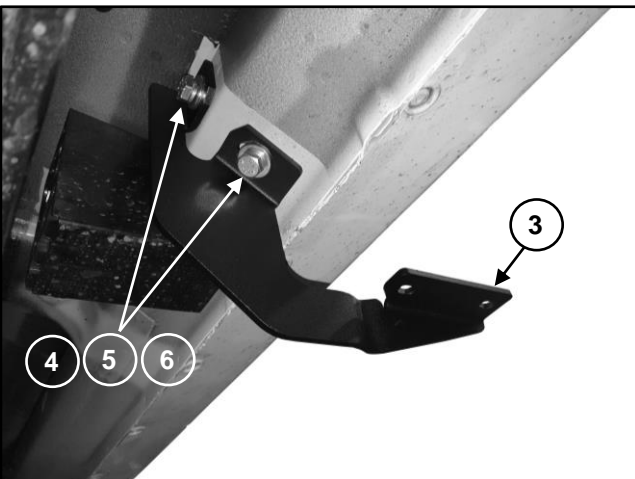

**Step 4. Attach the Centre & Rear Bracket [Item 3] to the centre mounting position using:**  
 2 x M10 Hex Bolts [Item 4]  
 2 x M10 Spring Washers [Item 5]  
 2 x M10 Flat Washers [Item 6]

Ensure the bracket is level and square, then finger tighten only.

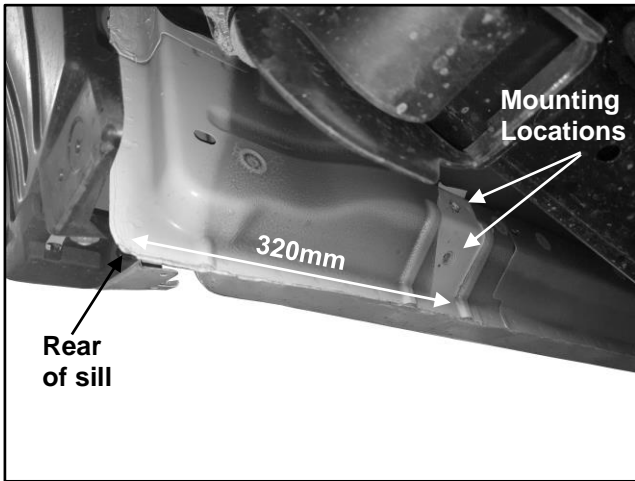

**Step 5. Move to the rear of the vehicle.**

Locate the rear bracket mounting position, approximately 320mm from the rear of the sill.

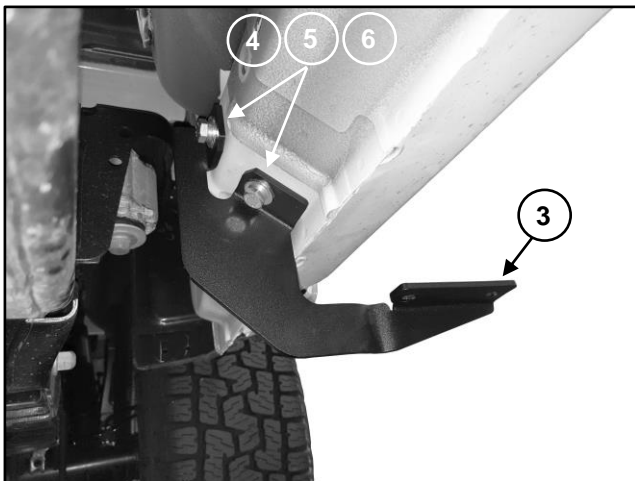

**Step 6. Attach the Centre & Rear Bracket [Item 3]**

to the rear mounting position using:

2 x M10 Hex Bolts [Item 4]

2 x M10 Spring Washers [Item 5]

2 x M10 Flat Washers [Item 6]

Ensure the bracket is level and square, then finger tighten only.



**Step 7. Repeat Steps 1 – 6 to fit the remaining brackets to the R/H (Driver's) side of the vehicle.**

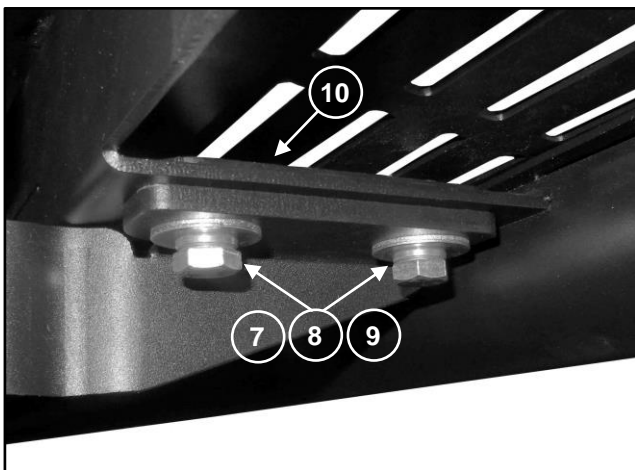

**Step 8. Install Steps to both sides of vehicle** using the following quantity of fasteners for each bracket:

2 x M8 Hex Bolts [Item 7]

2 x M8 Spring Washers [Item 8]

2 x M8 Flat Washers [Item 9]

1 x M8 Mounting Nut Assembly [Item 10]

Position steps 5-10 mm behind front mud flaps. **After ensuring correct positioning and alignment, tighten all M8 fasteners to 13Nm and all M10 fasteners to 17Nm.**

- **Place “KINGSLEY SIDE STEP Warranty” on customer’s front seat**
- **Clean the Side Steps if necessary using PH - Neutral soapy water ONLY**

**Your Side Steps are now ready for use**