

Kingsley

STEPBOARDS®

FITTING INSTRUCTIONS

Part No: 18J270
Jeep Grand Cherokee 4WD
Model Commencing 6/2005

END CAPS / MUDFLAPS: **Front – 1 pair Plastic BULLNOSE**
 Rear – 1 pair Plastic UPSWEPT

HARDWARE KIT CONTENTS

ITEM NO.	DESCRIPTION	QTY
1	M8 x 20mm Flange bolt	12
2	M8 Flange Nut	32
3	M8 x 20mm Bolt	12
4	M8 x 11mm Flange Bolt	12

ITEM NO.	DESCRIPTION	QTY
5	22mm Tech Screw	6
6	M8 x 14mm Bolt	8
7	M8 Hex Nut	12
8	Rust Inhibiting Compound	1

STEPBOARD BRACKETS

PART NO.	DESCRIPTION	QTY
9AV027	Front, Centre, Rear Bracket	6
9AV028	Common Plate	6
-	-	-
-	-	-

BEFORE INSTALLATION: PLEASE READ THESE INSTRUCTIONS CAREFULLY BEFORE INSTALLATION, PAYING SPECIAL ATTENTION TO ALL 'NOTES'. FAILURE TO DO SO MAY RESULT IN DAMAGE OF PARTS AND/OR INJURY TO INSTALLER OR CUSTOMER.

TOOLS REQUIRED: • ELECTRIC DRILL OR EQUIV • TAPE MEASURE • 13MM SOCKET & RATCHET • 13MM RING/OPEN SPANNER • TORQUE WRENCH.

FITTING PROCEDURE

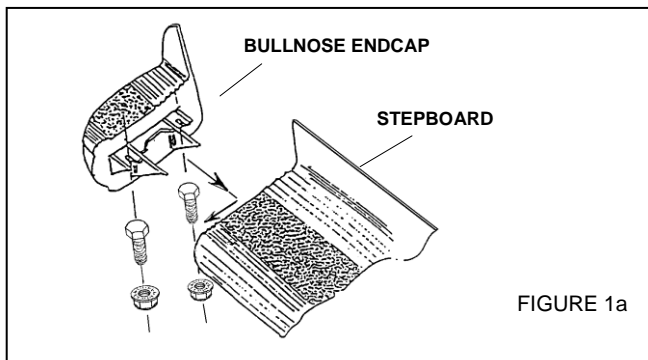

1. **Assemble the side step as follows:** Attach a moulded EndCap to one side step using two (2) M8 x 14mm bolts (gold colour) and two (2) M8 flange nuts, **See figure 1a.**

IMPORTANT: BEFORE YOU TIGHTEN THE ENDCAP, MAKE SURE THAT YOU PULL THE ENDCAP OUT SO THAT THE ENDCAP EDGE FULLY COVERS THE RAISED FEATURES ON THE SIDE STEP EDGE, **See figure 1b.**

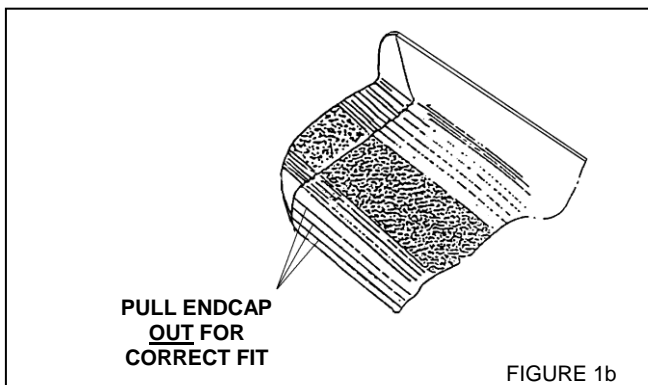

- a. Slide into each of the underside channels of the side step three (3) M8 hex nuts, that is, six (6) per side step
- b. Complete the Stepboard Assembly by attaching to the rear of the board the upswept endcap in the same manner as for part 1. **See Figures (1a & 1b)**

Repeat for the remaining board and place the Stepboards in a safe place to prevent damage.

2. Assemble all 6 Brackets.

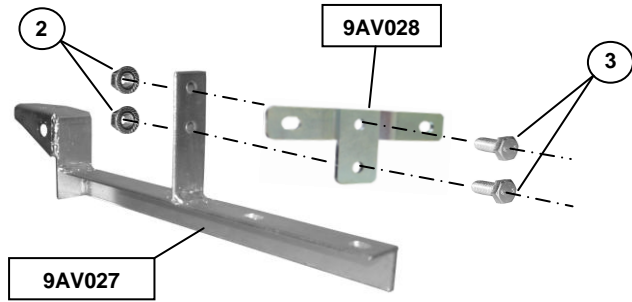

3. Move to the R/H (Drivers) side of the vehicle and proceed as follows.

Locate front mounting position approx. 300mm from the front wheel arch and install bracket. See Fig 3a.

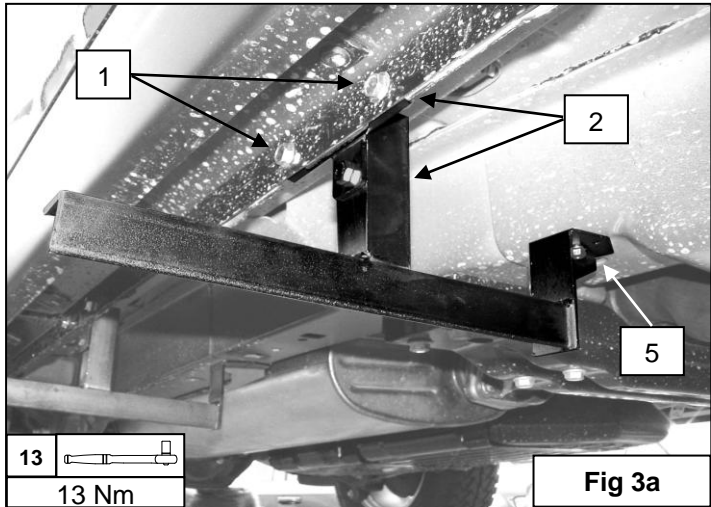

NOTE: If sill holes do not line up to insert item 1 (M8x20mm flange bolt), drill sill holes to a diameter of 8.5mm. Use Kingsley rust inhibitor (Item 8) on raw metal edges.

3b. Select hole in rear of bracket that is over chassis rail. Pre drill hole to Ø5.5mm and apply rust inhibiting compound to raw metal edges (item 8). Insert 1 tech screw (item 5) to secure bracket.

4. Now install Centre & Rear brackets in the same manner as in step 2. Mounting locations are 925mm & 340mm from rear wheel arch respectively.

5. Lift the Side Step back onto the brackets and position in the centre of the wheel arches. Secure the side step to the brackets using two M8 x 11mm flange bolts per bracket (item 4) picking up nuts in the channels of the Side Step. Ensure board is level and parallel to sill. Finger tighten only. (See fig.5)

6. Check that the Side Step is pushed in and parallel to the sill. Finally tighten all nuts and bolts before using the Side Step. Recommended max torque: **13Nm**.

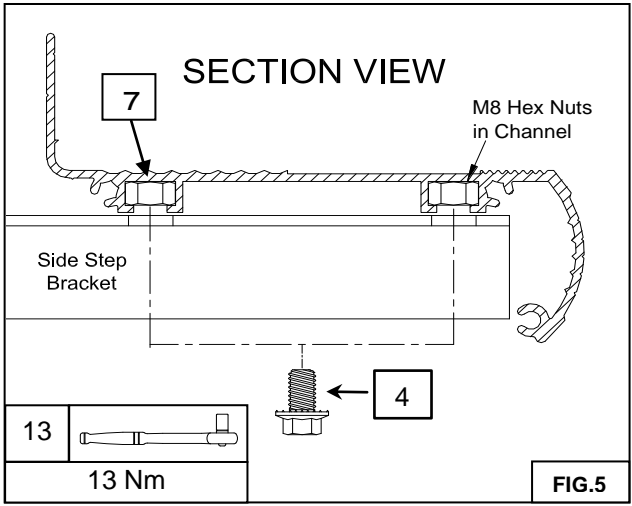

7. Now complete steps 1 – 6 for the L/H (Passenger) side of vehicle.

- Place “KINGSLEY SIDE STEP Warranty” on customer’s front seat
- Clean the side steps if necessary using PH - Neutral soapy water ONLY

Your Stepboards are now ready for use

*In accordance with our policy of total quality commitment and customer service, we invite you to contact us on our toll free hotline should you have any questions
Telephone: (02) 9792 2566 or Toll Free 1800 654 767*