

2.11

REFIT TOP HAT

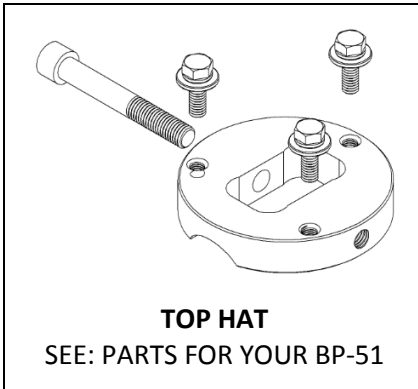

PARTS



TOOLS

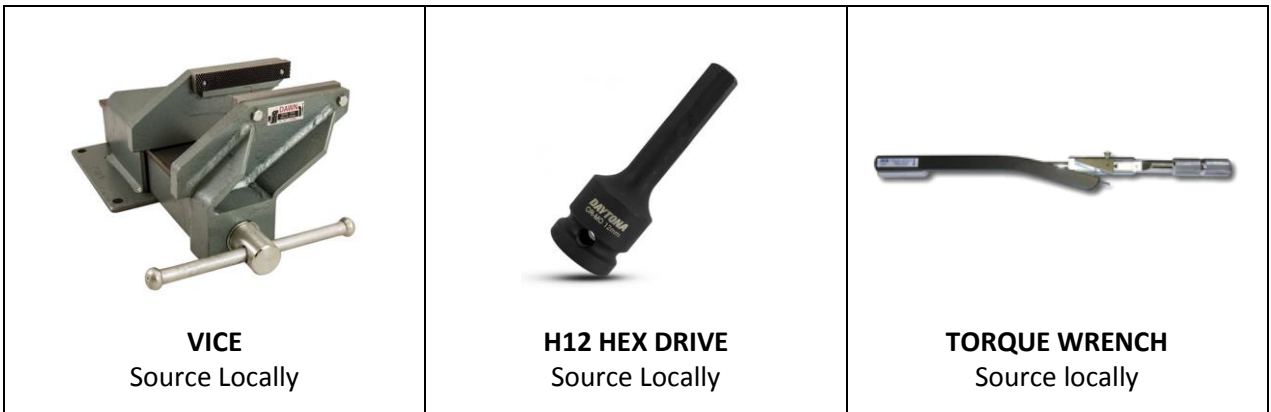

TOP HAT FITMENT PROCESS

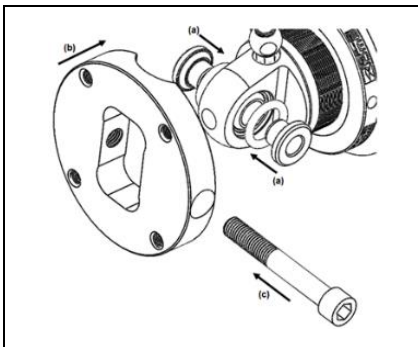

1.

- a) Clamp the O-rings and Reducers against the Spherical Bearing using welding clamps or multigrips.
- b) Slide Top Hat over the Reducers.
- c) Insert the M14 Bolt.

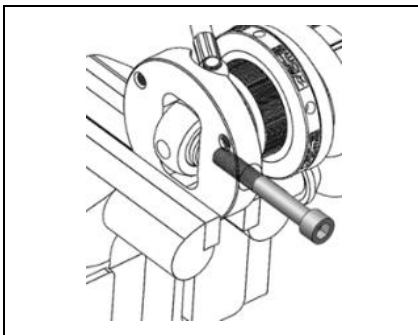
2. With the assembly in the vice torque to **226 Nm**.

WARNING: Do not attempt to fasten the Bolt with a Rattle Gun without the Top Hat in a Vice. The Top Hat will rotate and break the Hose Fitting off the Body Cap.